

Gullwing Shelter

- Available in a range of configurations & sizes
- Modular, flexible & innovative design & construction
- Contemporary architectural aesthetics & detailing
- Engineering grade construction & materials
- Future proofed & technology enabled
- Incorporates Intelligent, electronic transport hardware
- Optimum passenger protection, comfort & safety
- Ultimate transport marketing platform
- Robust and vandal resistant
- Range of high grade material & finish options for long lasting performance
- Quick release yet tamper proof features for rapid, cost effective maintenance
- Compliant with BSI structural standards & regulations
- Fully DDA & ADA compliant
- Ability to accept RTPPI displays, CCTV, audio PA, solar, kiosks and other advanced information systems
- Range of foundation and installation options available
- Range of glazing materials and options available
- Special 'shock absorbing' glazing retention system
- The choice of many major Cities

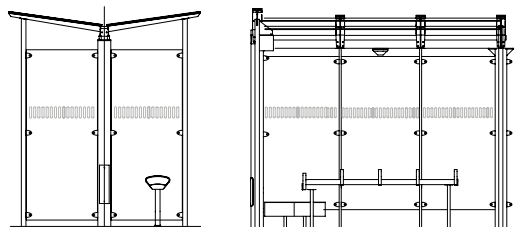

→ Looking for more detailed information?

☎ (845) 570 2745 🌐 www.futuresystems-inc.com ✉ sales@futuresystems-inc.com

future
systems inc

Fishergate Gullwing Shelter

- Available in a range of configurations & sizes
- Modular, flexible & innovative design & construction
- Contemporary architectural aesthetics & detailing
- Engineering grade construction & materials
- Future proofed & technology enabled
- Incorporates Intelligent, electronic transport hardware
- Optimum passenger protection, comfort & safety
- Ultimate transport marketing platform
- Robust and vandal resistant
- Range of high grade material & finish options for long lasting performance
- Quick release yet tamper proof features for rapid, cost effective maintenance
- Compliant with BSI structural standards & regulations
- Fully DDA & ADA compliant
- Ability to accept RTPPI displays, CCTV, audio PA, solar, kiosks and other advanced information systems
- Range of foundation and installation options available
- Range of glazing materials and options available
- Special 'shock absorbing' glazing retention system
- The choice of many major Cities



→ Looking for more detailed information?

☎ (845) 570 2745

🌐 www.futuresystems-inc.com

✉ sales@futuresystems-inc.com

future
systems inc

Gullwing BRT Shelter

- Available in a range of configurations & sizes
- Modular, flexible & innovative design & construction
- Contemporary architectural aesthetics & detailing
- Engineering grade construction & materials
- Future proofed & technology enabled
- Incorporates Intelligent, electronic transport hardware
- Optimum passenger protection, comfort & safety
- Ultimate transport marketing platform
- Robust and vandal resistant
- Range of high grade material & finish options for long lasting performance
- Quick release yet tamper proof features for rapid, cost effective maintenance
- Compliant with BSI structural standards & regulations
- Fully DDA & ADA compliant
- Ability to accept RTPi displays, CCTV, audio PA, solar, kiosks and other advanced information systems
- Range of foundation and installation options available
- Range of glazing materials and options available
- Special 'shock absorbing' glazing retention system
- The choice of many major Cities



→ Looking for more detailed information?

☎ (845) 570 2745

🌐 www.futuresystems-inc.com

✉ sales@futuresystems-inc.com

future
systems inc

Gullwing Heritage Shelter

- Available in a range of configurations & sizes
- Modular, flexible & innovative design & construction
- Aesthetics & detailing to compliment historic locations
- Engineering grade construction & materials
- Future proofed & technology enabled
- Incorporates Intelligent, electronic transport hardware
- Optimum passenger protection, comfort & safety
- Ultimate transport marketing platform
- Robust and vandal resistant
- Range of high grade material & finish options for long lasting performance
- Quick release yet tamper proof features for rapid, cost effective maintenance
- Compliant with BSI structural standards & regulations
- Fully DDA & ADA compliant
- Ability to accept RTPi displays, CCTV, audio PA, solar, kiosks and other advanced information systems
- Range of foundation and installation options available
- Range of glazing materials and options available
- Special 'shock absorbing' glazing retention system
- The choice of many major Cities



→ Looking for more detailed information?

☎ (845) 570 2745

🌐 www.futuresystems-inc.com

✉ sales@futuresystems-inc.com

future
systems inc

Loughborough Gullwing Shelter

- Available in a range of configurations & sizes
- Modular, flexible & innovative design & construction
- Contemporary architectural aesthetics & detailing
- Engineering grade construction & materials
- Future proofed & technology enabled
- Incorporates Intelligent, electronic transport hardware
- Optimum passenger protection, comfort & safety
- Ultimate transport marketing platform
- Robust and vandal resistant
- Range of high grade material & finish options for long lasting performance
- Quick release yet tamper proof features for rapid, cost effective maintenance
- Compliant with BSI structural standards & regulations
- Fully DDA & ADA compliant
- Ability to accept RTPi displays, CCTV, audio PA, solar, kiosks and other advanced information systems
- Range of foundation and installation options available
- Range of glazing materials and options available
- Special 'shock absorbing' glazing retention system
- The choice of many major Cities



→ Looking for more detailed information?

☎ (845) 570 2745

🌐 www.futuresystems-inc.com

✉ sales@futuresystems-inc.com

future
systems inc